



Manufactured by :
F.M. S.r.L.
Via Brignano , 41- 24047 Treviglio -BG- I-

TECHNICAL SPECIFICATION

REVISION
0

DATE

14.02.14

PAGE

Pagina 1
di 5

OBJECT:
Speedy Jet automatic
spray Nozzle and
controllers

REPLACING :
EFFECTIVE FROM:

REFERENCE STANDARDS:

WARNING:UNCONTROLLED PAPER COPY

QUALITY DOCUMENT
CONTROLLED DISTRIBUTION-VALID FOR ENFORCEMENT
Confidential property. Reproduction and distribution are prohibited by law.

REVISION		
Index	Date	Description
REV.0	14.02.2014	FIRST ISSUE



Manufactured by :
F.M. S.r.L.
Via Brignano , 41- 24047 Treviglio -BG- I-

TECHNICAL SPECIFICATION

REVISION
0

DATE

14.02.14

PAGE

Pagina 2
di 5

OBJECT:
Speedy Jet automatic
spray Nozzle and
controllers

REPLACING :
EFFECTIVE FROM:

0) APPLICATION

Provides accurate spray placement and spray pattern integrity in high-speed and low-capacity applications.



OBJECT:
Speedy Jet automatic
spray Nozzle and
controllers

REPLACING :
EFFECTIVE FROM:

1) DESCRIPTION.

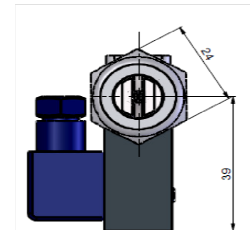
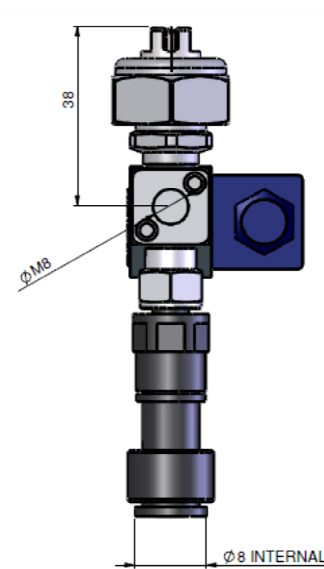
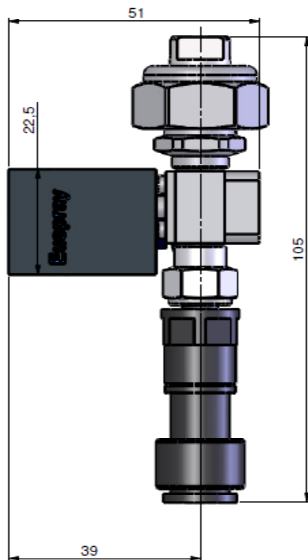

The flow rate is determined by the type of nozzle installed (free passage max. 1,5 mm)

2) TECHNICAL DESCRIPTION.

MATERIALS IN CONTACT WITH FLUID

Body aisi 316

Sealing fpm

Seat aisi 316

Internal components aisi 316

Guide assembly aisi 316

Maximum allowable pressure 16 bar

Opening time 5 ms

Closing time 5 ms

Fluid temperature 0°+ 130°

Max viscosity 3°E 22 cStokes or mm²/s

Continuous duty ED100%

Encapsulation material PET

Coil insulation class F (155° C)

Ambient temperature -10°C +60°C

Protection degree IP65 (EN60529) with plug micro-connectors

Electrical connections DIN 46340 – 3 micro poles connectors

Voltage 24VDC (+10% -5%)



Manufactured by :
F.M. S.r.L.
Via Brignano , 41- 24047 Treviglio -BG- I-

TECHNICAL SPECIFICATION

REVISION
0

DATE

14.02.14

PAGE

Pagina 4
di 5

OBJECT: Speedy Jet automatic spray Nozzle and controllers

**REPLACING :
EFFECTIVE FROM:**

3)BENEFITS.

- **Operation at high speed, up to 6,000 cycles per minute, is ideal on fast production lines and increase the production.**
- **Using our system Pulse Width Modulated (PWM) with the Speedy Jet spray nozzle is possible have a very precise control of the flow rate and spray angle, thanks to an on-off very quickly.**
- **Flow rate can be changed almost instantaneously, usually changing time of on-off of the control system.**
- **Different flow rates can be achieved with a single model of nozzle.**
- **Low flow rates can be achieved by using large free passage nozzles reducing the risk of clogging.**
- **Use of Speedy Jet minimizes overspray and possible consequent risk on health, saves on the consumption in the presence of expensive liquids.**
- **Is possible to obtain a wide range of capacities, using only one type of nozzle, reducing costs.**

4)CONTROLLERS.

- **Another strong point of the system is the Speedy Jet controllers, is simplicity in programming, making it ideal where is also required high flexibility for production.**
- **The controllers comes with a program to download on customer's computer, connecting through an adapter USB-RS232 to the controllers you can change the timing parameters on-off in a few seconds and then restart production very quickly reducing costs.**
- **After changing the parameters, the computer gets disconnected.**
- **The software allows to save different configurations set and then store them on your PC, when prompted just enter the required configuration in the controller and in a very short time you change the parameters in production.**
- **The controller requires a 220V single-phase power supply.**
- **Each controller can control up to 8 Speedy Jet.**
- **The start for the spraying cycle is always done by sending a signal PNP to the control system with photocell, proximity or PNP signal created by customer. The inputs for PNP signals are 2 (each input signal can control 4 Speedy Jet Guns).**



Manufactured by :
F.M. S.r.L.
Via Brignano , 41- 24047 Treviglio -BG- I-

TECHNICAL SPECIFICATION

REVISION
0

DATE

14.02.14

PAGE

Pagina 5
di 5

OBJECT:
Speedy Jet automatic
spray Nozzle and
controllers

REPLACING :
EFFECTIVE FROM:

DRIVERS PRESENT IN THE CONTROLLERS

