

## LSMOD3L

### Caratteristiche

Le teste rotanti sono costruite in acciaio inossidabile aisi 316, sono montate su cuscinetti a sfere. Tutte le superfici interne ed esterne sono lavorate con macchine utensili ad alta precisione garantendo una finitura liscia e un'ottima qualità del prodotto. Le teste sono disponibili con attacco filetto femmina o maschio BSP (GAS).

### Applicazioni

- Lavaggio serbatoi

### Materiali

- Aisi316L
- altri a richiesta

### Characteristics

The rotating heads are made of stainless steel AISI 316 and they are placed on two spherical bearings. All the internal and external surfaces are machined worked with accuracy and they are smooth. The heads are available in two different connections: female or male thread BSP (GAS).

### Application:

- Tank washing

### Materials:

- Aisi316L
- other on request

### Características

Las cabezas giratorias están construidas en acero inoxidable AISI 316, y se montan sobre cojinetes de bolas. Todas las superficies internas y externas están trabajadas con máquinas herramienta de alta precisión que garantizan un acabado liso y una excelente calidad de producto. Los cabezales se presentan con conexión de rosca hembra o macho BSP (GAS).

### Aplicación:

- Lavado de tanques

### Materiales:

- Aisi316L
- otros bajo pedido

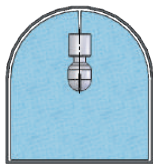

360°

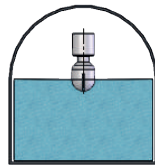

180° DOWN

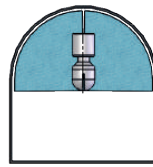

180° UP

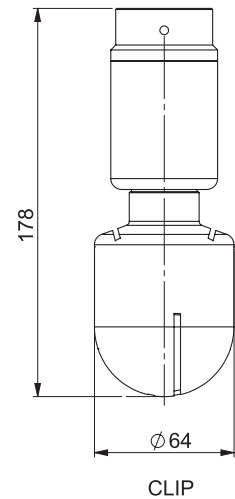
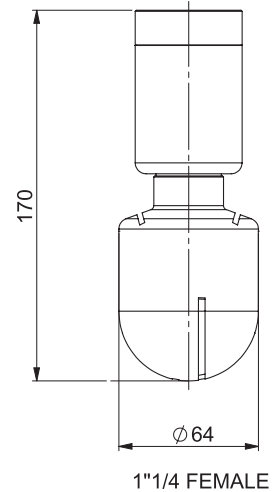

Mod.	Capacity		Pressure	Coverage	Thread		MAX. WET RADIUS (MT.)
	1	2	3		Female (BSP)	Clip (mm)	
<b>ALSMOD 3L.1</b>	200	258	<b>300</b>	360°	1 1/4"		3.2 + 4.6
<b>ALSMOD 3L.2</b>	133,3	196,6	<b>233,3</b>	180°	1 1/4"		3.2 + 4.6
<b>ALSMOD 3L.3</b>	200	258	<b>300</b>	360°		Ø 38.5 + 40.5	3.2 + 4.6
<b>ALSMOD 3L.4</b>	133,3	196,6	<b>233,3</b>	180°		Ø 38.5 + 40.5	3.2 + 4.6