



# K-SYSTEM



Complete Riser and Nozzle Systems

K-Ball®

# Clip-On Spray Nozzles & Assemblies

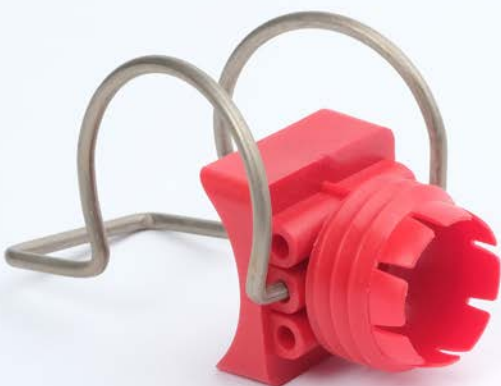

For multi stage washers and spray wash machines.



Dependable quality from the leader in clip-on nozzle systems.

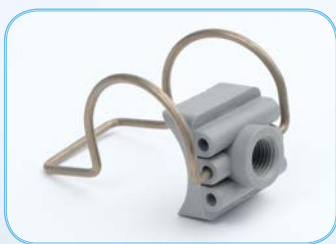

## Assemblies - Angular Adjustment

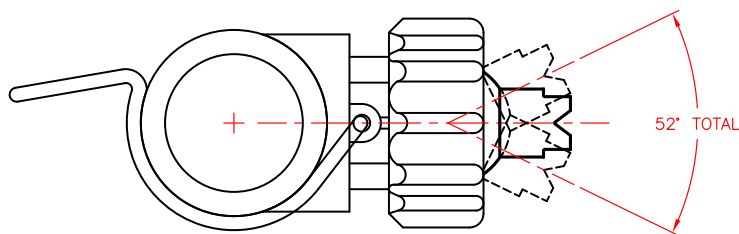

## K-Ball® Body Colors and Part Numbers

Pipe Sizes	1"	1-1/4"	1-1/2"	2"
Standard Body	1K (white)	1.2K (grey)	1.5K (black)	2K (tan)
Body with Fingers	1KF (green)	1.2KF (yellow)	1.5KF (red)	2KF (blue)
Spring Clip	1KCL	1.2KCL	1.5KCL	2KCL
O-Ring KOR	KOR	KOR	KOR	KOR
K-Ball Cap	KCAP	KCAP	KCAP	KCAP



# K-System Riser Assemblies

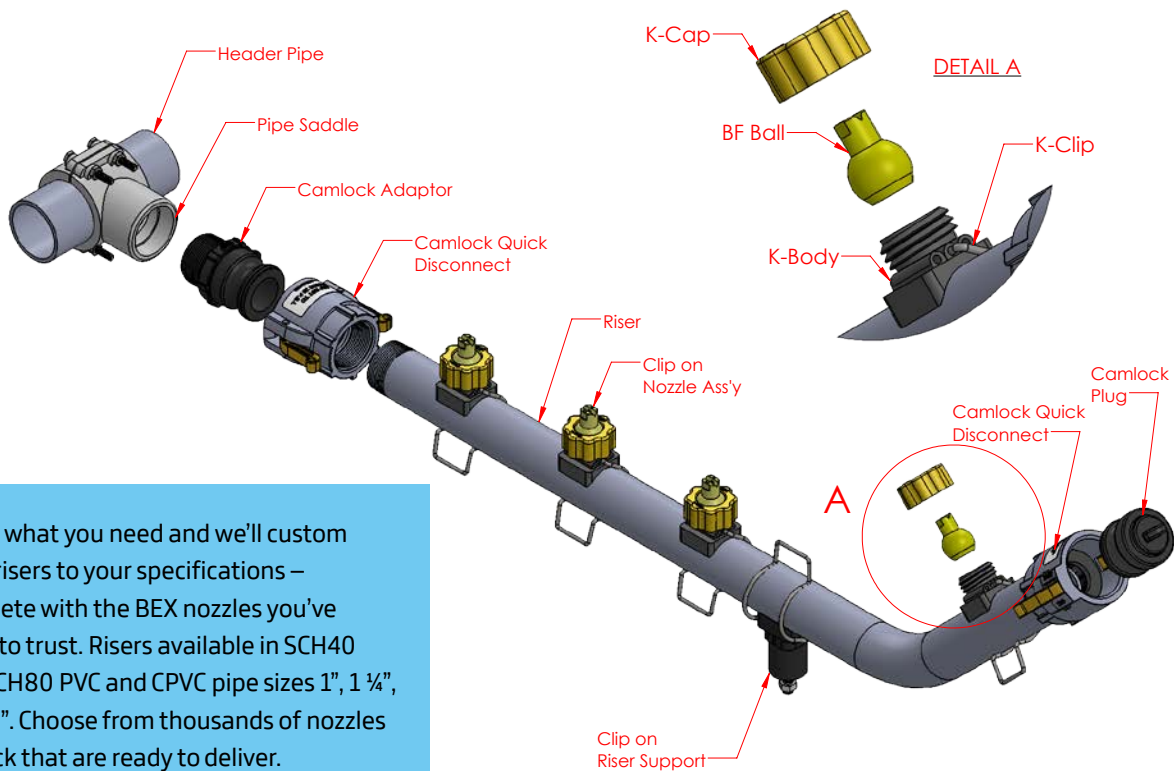

Tell us what you need and we'll custom build risers to your specifications – complete with the BEX nozzles you've come to trust. Risers available in SCH40 and SCH80 PVC and CPVC pipe sizes 1", 1 ¼", 1 ½", 2". Choose from thousands of nozzles in stock that are ready to deliver.

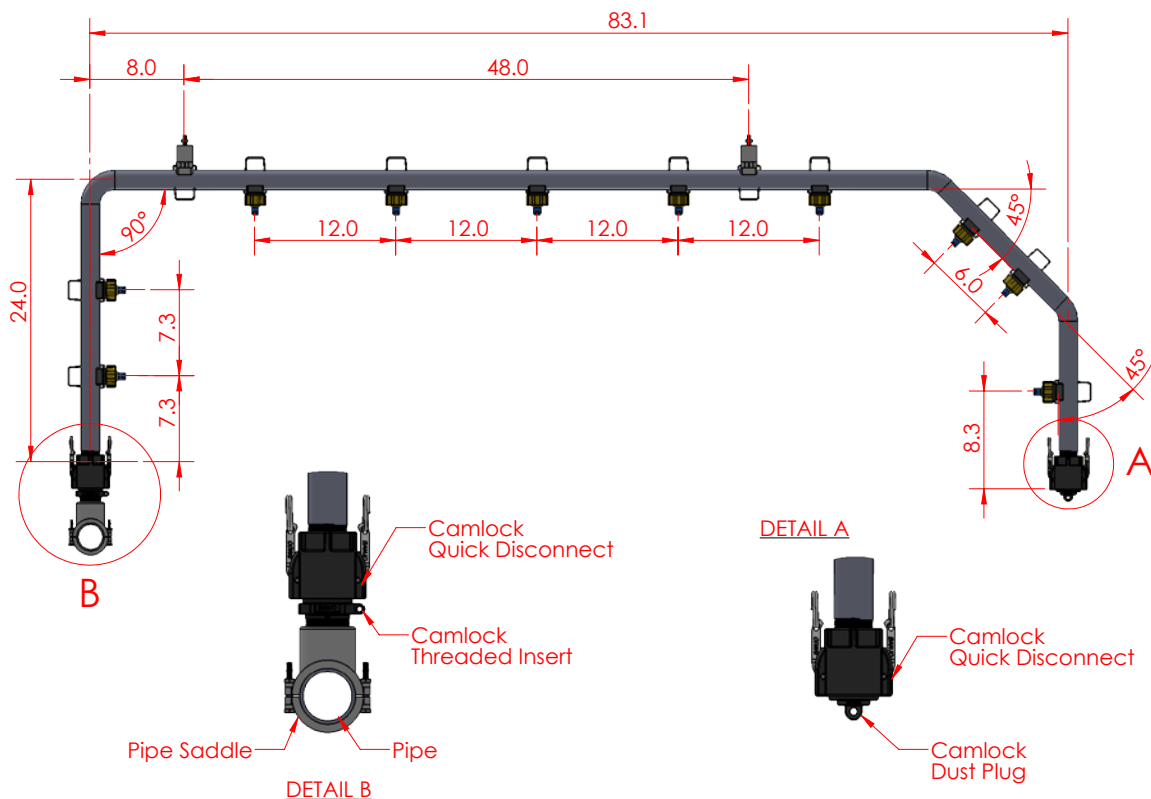

# K-System Riser Components

**Saddles**



**Camlocks**



**Ball Valves**



**Tee Fittings**



Glued Threaded

**End Caps**



Glued Threaded

**Elbow Fittings**



Glued Threaded

## How to Order K-SYSTEM Risers

- 1** Draw up a plan of your riser, or have one of our sales reps assist you.
- 2** As a minimum, we would need to know:
  - Length, pipe spec (eg. 1" sched 40 PVC), quantity, number and type of nozzles,
  - Number of bends, angle of bends, tees, caps, elbows, riser clamps, as well as any cam locks, saddles etc.
  - Risers are typically sized based on the largest part to wash.
- 3** Submit plan to BEX for an estimate.
- 4** A quote and a drawing will be supplied to you for your approval.
- 5** Submit a PO together with the approved drawing to BEX.
- 6** Your unique riser part number will be assigned.
- 7** Production begins.
- 8** Risers are inspected and packaged.



# K-System Nozzle Components



## KZ Sub-assembly

Use our complete range of plastic Zip-Tips® in the K-Ball System with our KZBD.

**ZF** Low flow rate flat fans < 1USGPM.

**ZS** Full cone sprays.

**ZSW** Full cone wide angle.

**ZSQ** Full cone square.



**ZF**



**ZS**



**ZSW**



**ZSQ**

## BF Balls



Flat fan patterns which taper at the edges to permit overlapping of sprays.

Available In angles ranging from zero to 110 degrees, & flow rates from 1 to 15 USGPM at 40 psi.

Color coded by flow rate for easy identification.

## BFL Balls



A wide, flat shaped spray with low impact. The spray is deflected 75 degrees down from the centerline of the nozzle.

Many different capacities available.

## BPH Balls



A hollow cone pattern with low impact for phosphating applications.

3 different capacities available.

## Threaded Balls



Expand your range of nozzle choices by using a threaded ball with any nozzle. Made of glass reinforced polypropylene, they are available in a variety of sizes ranging from 1/8 to 1/2 NPT or BSPT.

## KPLUG



Shut-Off plug

Completely shut off the water flow through a clip-on opening.

## KCOR



Conversion O-Ring

Used instead of KOR when installing on pipe that has been drilled to 21/32.

## KRCX



Riser Support

Used to secure your riser to the wall of the washer.



## Concerned about water consumption?

Water is wasted in many applications, in many ways:

- Poor connections,
- Wrong size/type nozzle for job,
- Worn out or damaged nozzles,
- Bad nozzle to pump match,
- Excessive overspray.

## How can BEX help? Introducing NOZZLE SYSTEM AUDITS

BEX can perform a system audit, to identify areas where improvements to nozzles, nozzle selection, piping, connections etc., will reduce wasted water, saving you money.

We will come to your wash station, to inspect your piping and nozzles to ensure the setup is optimal for your operation. We will provide you with a detailed report, including suggestions on where improvements can be made.



### **BEX, Inc.**

836 Phoenix Dr  
Ann Arbor, MI  
48108 USA  
T 734-389-0464  
F 734-389-0470  
sales@bex.com

### **BEX Engineering Ltd.**

5115 Timberlea Blvd  
Mississauga, ON  
Canada, L4W 2S3  
T 905-238-8920  
F 905-238-8955  
info@bex.com

### **BEX, GmbH**

Siemensring 44N  
D-47877 Willich  
Deutschland  
T 49 2154/88 70 06  
F 49 2154/88 70 09  
deutschland@bex.com